

# 3x6-18 JC

## Pump for High Shear Slurries

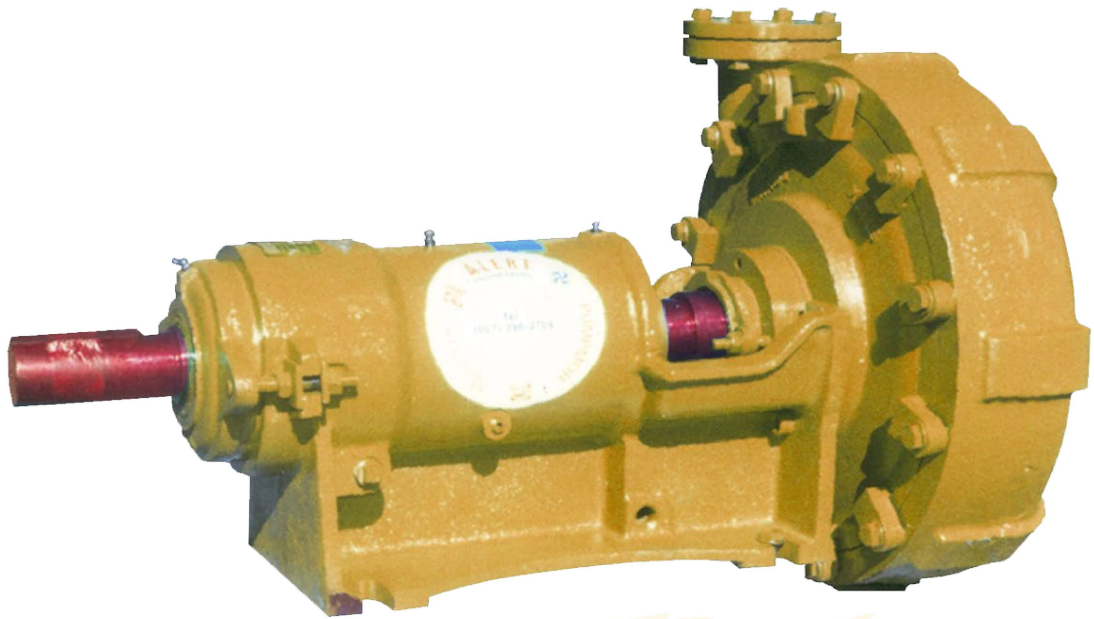

### INDUSTRY APPLICATIONS:

Developed to pump high shear & shear sensitive slurries.

Commonly found in the Kaolin and paper coating industries, shear sensitive slurries thicken with increasing impeller rpm, sometimes to the point of overloading the motor and shutting down the pump. The 3x6-18 is designed to deliver a given flow and head at a lower impeller rpm (not top speed) than the standard design Model JC 3 and 4 inch pumps.

### DESIGN FEATURES:

- Single volute casing with back pullout.
- Enclosed, 5 vane impeller to reduce shear.
- Large casing clearances around front and back impeller shrouds to reduce shear.

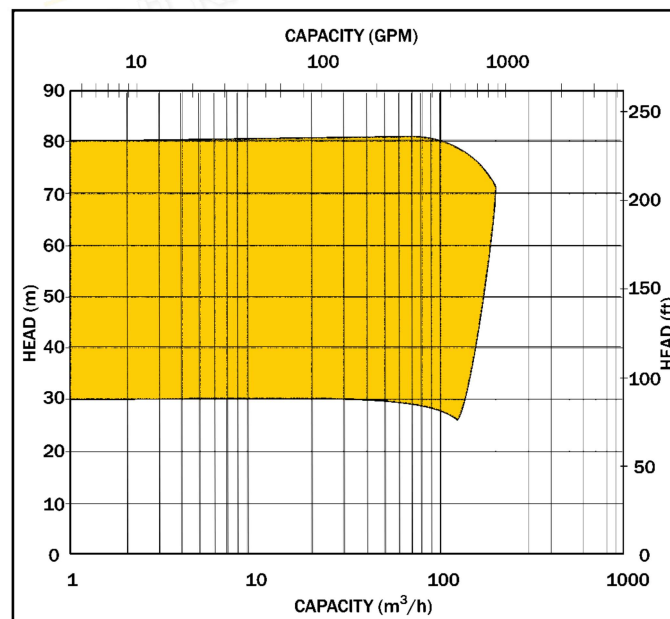

### CAPABILITIES:

- Maximum solids handling size of 15,5mm and SG's to 1.5.

### PERFORMANCE:

- Heads of up to 80m can be achieved at speeds of less than 1800 rpm

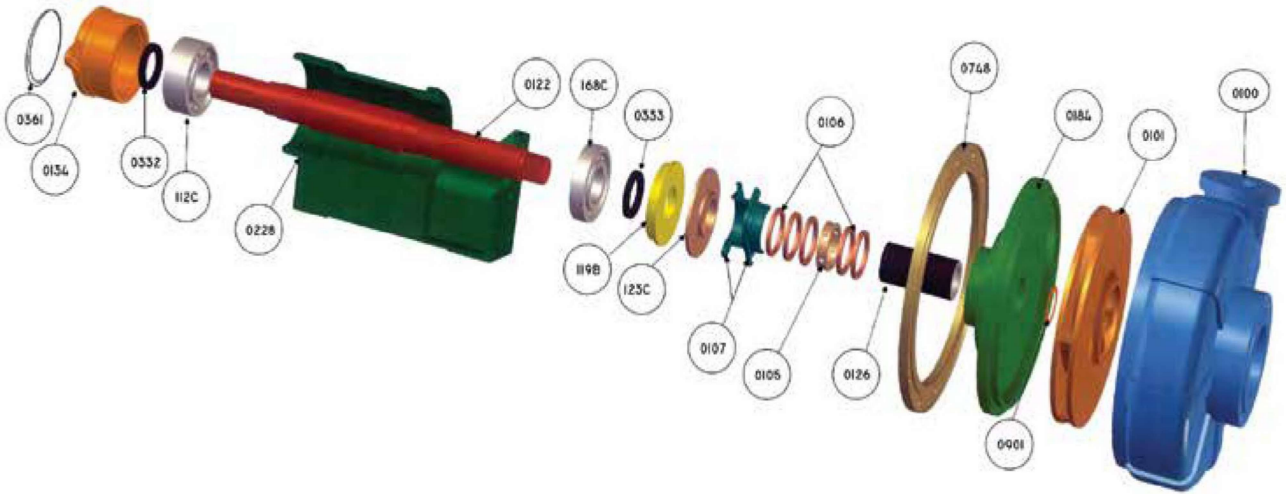

### Parts Identification

0100	Casing	0228	Bearing Frame
0101	Impeller	0332	Outboard Seal
0105	Lantern Ring	0333	Lip Seal
0106	Packing	0361	Circlip
0107	Gland	0748	Fastening Ring
0122	Shaft	0901	Gasket (Sleeve)
0126	Shaft Sleeve	112C	Thrust Bearing
0134	Thrust Bearing Housing	119B	Inboard Bearing End Cover
0184	Stuffing Box Cover	123C	Deflector
		168C	Radial Bearing

