



Connectors on request



Application

- It is widely used for heating ventilating and air conditioning (HVAC) circulation, pressure boosting of hot water in family, homes powered by solar energy, industrial auxiliary equipment cold and hot water circulation and so forth
- Water circulation for the central and district heating system
- Domestic hot water circulation

Pump

- Bronze or anti-rust cast iron pump body
- Noryl impeller with heat resistance up to 150°C
- 95% alumina ceramic shaft
- Liquid temperature: 2°C - 110°C

Motor

- Insulation class: H
- Protection class: IP44
- 99% alumina ceramic bearing
- Copper winding
- Three speed motor

Identification Codes

LRP 15 - 50 B / 130

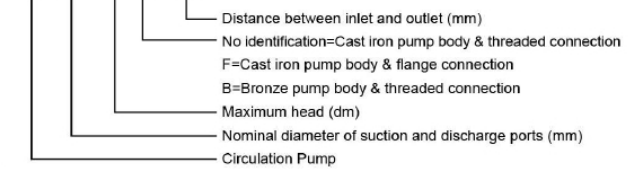

Model	L (mm)	B (mm)	B1 (mm)	H (mm)	H1 (mm)	G
LRP15-40/130	130	125	75	130	25	G1
LRP15-40B/130	130	125	75	130	25	G1
LRP20-40/130	130	125	75	130	25	G1.25
LRP25-40/130	130	125	75	130	25	G1.5
LRP25-40/180	180	125	75	130	25	G1.5
LRP32-40/180	180	125	75	135	30	G2
LRP15-50/130	130	125	75	130	25	G1
LRP15-50B/130	130	125	75	130	25	G1
LRP20-50/130	130	125	75	130	25	G1.25
LRP25-50/130	130	125	75	130	25	G1.5
LRP25-50/180	180	125	75	130	25	G1.5
LRP32-50/180	180	125	75	135	30	G2
LRP15-60/130	130	125	75	130	25	G1
LRP15-60B/130	130	125	75	130	25	G1
LRP20-60/130	130	125	75	130	25	G1.25
LRP25-60/130	130	125	75	130	25	G1.5
LRP25-60/180	180	125	75	130	25	G1.5
LRP32-60/180	180	125	75	135	30	G2
LRP25-70/130	130	125	75	130	25	G1.5
LRP25-70/180	180	125	75	130	25	G1.5
LRP32-70/180	180	125	75	135	30	G2
LRP25-80/180	180	134	75	154	25	G1.5
LRP25-120/180	180	148	75	155	25	G1.5
LRP32-80/180	180	137	75	168	40	G2

Dimension Drawing

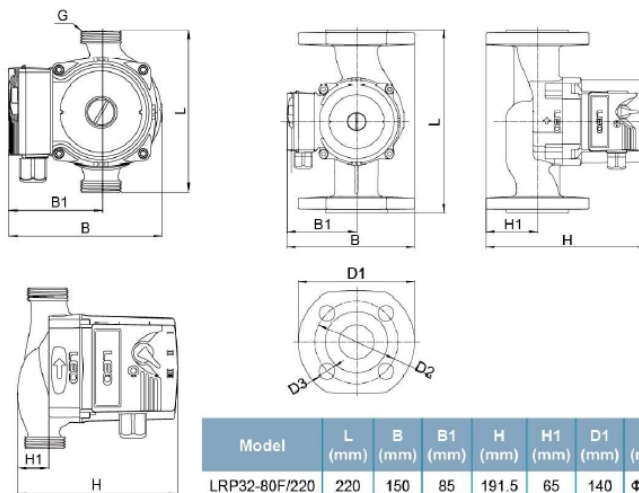

Model	L (mm)	B (mm)	B1 (mm)	H (mm)	H1 (mm)	D1 (mm)	D2 (mm)	D3 (mm)
LRP32-80F/220	220	150	85	191.5	65	140	Φ100	Φ19
LRP36-80F/200	200	138	85	174.5	45	90	Φ90	Φ11.5
LRP40-80F/250	250	155	85	196.5	70	150	Φ110	Φ19

LRP

Circulation Pump

Model	Voltage /Frequency (V/Hz)	Power(W)			Max. Flow (l/min)	Max.Head (m)	N.W. (kgs)	G.W. (kgs)	Packing Size (mm)
		3	2	1					
LRP15-40/130	220~240/50Hz	67	58	40	46/42/30	4.5/4.4/3.6	2.32	2.45	165x150x140
LRP15-40B/130	220~240/50Hz	67	58	40	46/42/30	4.5/4.4/3.6	2.41	2.54	165x150x140
LRP20-40/130	220~240/50Hz	68	59	40	51/46/32	4.3/4.1/3.6	2.37	2.5	165x150x140
LRP25-40/130	220~240/50Hz	72	63	42	60/55/33	4.6/3.3/2.3	2.44	2.57	165x150x140
LRP25-40/180	220~240/50Hz	73	64	43	64/58/35	4.6/4.3/3.9	2.55	2.71	195x150x140
LRP32-40/180	220~240/50Hz	69	60	41	60/54/37	4.3/4.0/3.4	2.73	2.89	195x150x140
LRP15-50/130	220~240/50Hz	85	60	40	40/32/23	4.5/3.8/2.5	2.32	2.45	165x150x140
LRP15-50B/130	220~240/50Hz	85	60	40	47/37/25	4.5/3.8/2.5	2.41	2.54	165x150x140
LRP20-50/130	220~240/50Hz	75	65	42	50/43/28	5.2/4.9/3.4	2.37	2.5	165x150x140
LRP25-50/130	220~240/50Hz	73	62	41	60/52/33	5.3/5.0/3.6	2.44	2.57	165x150x140
LRP25-50/180	220~240/50Hz	75	66	43	63/53/35	5.2/4.9/3.2	2.55	2.71	195x150x140
LRP32-50/180	220~240/50Hz	73	65	42	63/54/35	5.2/4.9/3.7	2.73	2.89	195x150x140
LRP15-60/130	220~240/50Hz	85	71	44	48/42/28	6.0/5.8/4.2	2.32	2.45	165x150x140
LRP15-60B/130	220~240/50Hz	85	71	44	48/42/28	6.0/5.8/4.2	2.41	2.54	165x150x140
LRP20-60/130	220~240/50Hz	96	69	45	53/37/25	5.5/4.5/2.8	2.37	2.5	165x150x140
LRP25-60/130	220~240/50Hz	83	70	43	58/43/28	5.5/4.5/2.8	2.44	2.57	165x150x140
LRP25-60/180	220~240/50Hz	83	69	44	68/60/35	6.1/5.8/4.5	2.55	2.71	195x150x140
LRP32-60/180	220~240/50Hz	85	77	44	66/58/38	5.9/5.5/4.1	2.73	2.89	195x150x140
LRP25-70/130	220~240/50Hz	150	130	105	67/50/37	6.3/6.0/5.2	2.45	2.61	165x150x140
LRP25-70/180	220~240/50Hz	150	130	105	67/50/37	6.3/6.0/5.2	2.57	2.73	195x150x140
LRP32-70/180	220~240/50Hz	150	130	105	67/50/34	6.3/6.0/5.2	2.75	2.91	195x150x140
LRP25-80/180	220~240/50Hz	200	190	160	120/100/60	7.1/6.5/5.5	4.23	4.57	196x196x160
LRP32-80/180	220~240/50Hz	270	245	160	167/100/60	7.3/6.7/5.4	4.75	5.09	195x196x160
LRP32-80F/220	220~240/50Hz	270	245	160	170/113/65	7.3/6.7/5.4	7.57	8	235x181x207
LRP36-80F/200	220~240/50Hz	270	245	160	170/113/65	7.3/6.7/5.4	5.98	6.36	214x170x190
LRP40-80F/250	220~240/50Hz	270	245	160	170/113/65	7.3/6.7/5.4	8.27	8.74	264x186x212
LRP25-120/180	220~240/50Hz	268	249	163	81/47/30	12/11/8	4.62	4.96	196x196x160

Materials Table

No.	Part	Material
1	Rotor	
2	Thrust bearing adjusting mat	Noryl
3	Thrust ring support	Silicon rubber
4	Bushings	Graphite
5	Front bearing	Alumina
6	Pump support cover	Stainless steel
7	Check ball	Silicon rubber
8	Locking	Stainless steel
9	Impeller	PPO
10	Pump body	Cast iron/Bronze
11	Pump body insert	Stainless steel
12	Back bearing	Alumina
13	Can brg asm	Stainless steel
14	Can brg asm seal	Silicon rubber
15	Stator cover(front)	PA66
16	Stator	
17	Stator cover(back)	PA66
18	Housing	ADC12
19	Drain plug	Copper
20	Speed regulation board	
21	Terminal cover	ABS
22	Terminal box	PC
23	Capacitor	

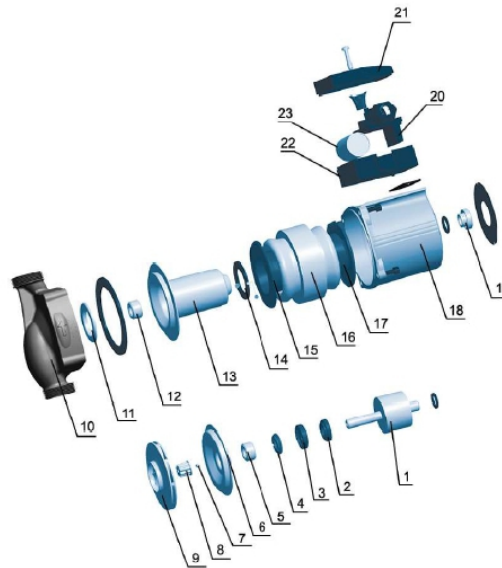



Hydraulic Performance Curves

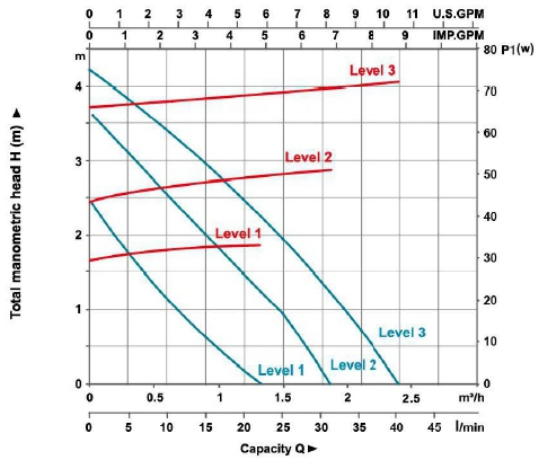

LRP15-40B/130
LRP15-40/130
— Q-H
— Q-P

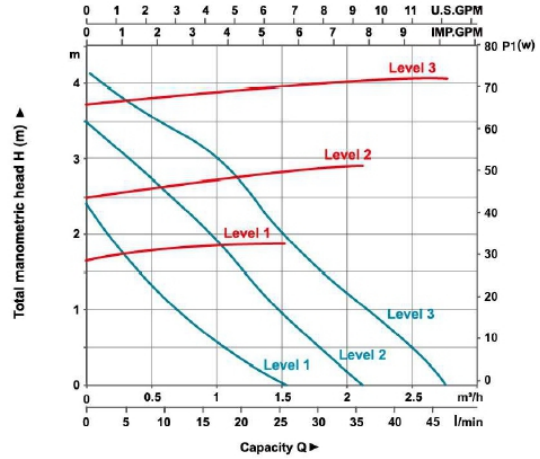

LRP20-40/130
— Q-H
— Q-P

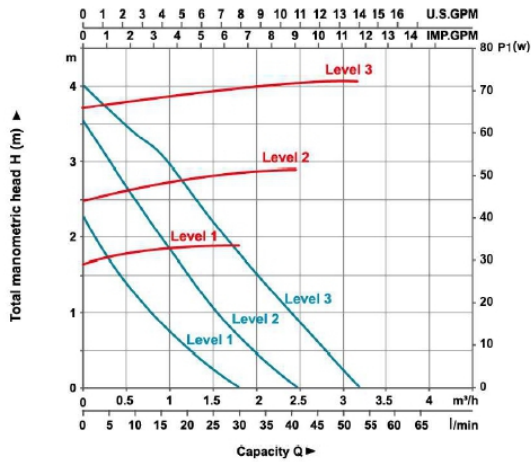

LRP25-40/130
— Q-H
— Q-P

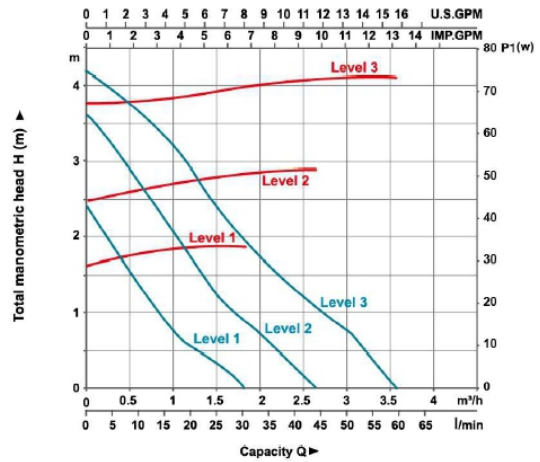

LRP25-40/180
— Q-H
— Q-P

Hydraulic Performance Curves

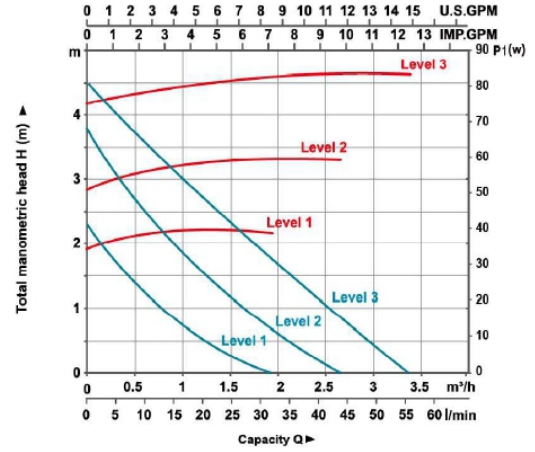
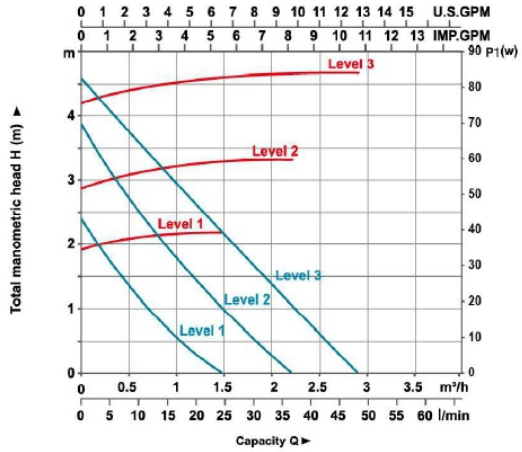
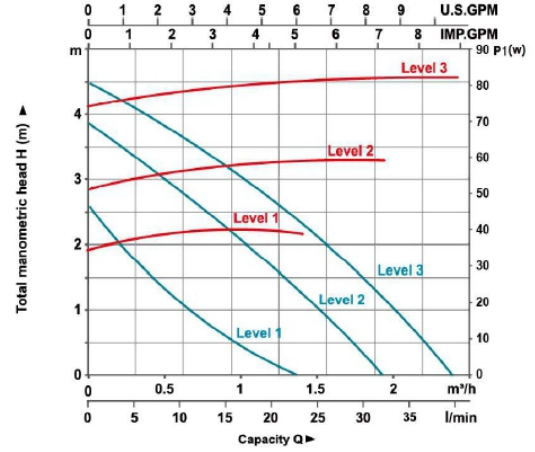
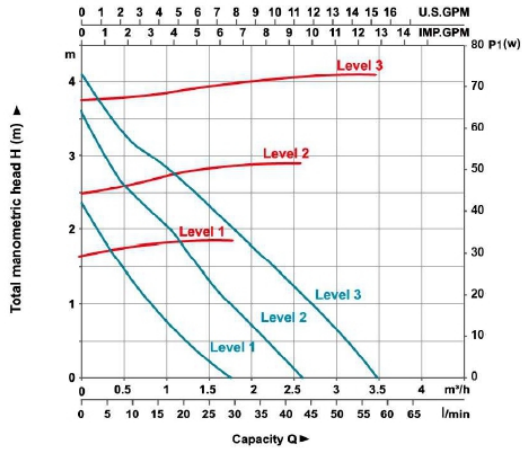



Hydraulic Performance Curves

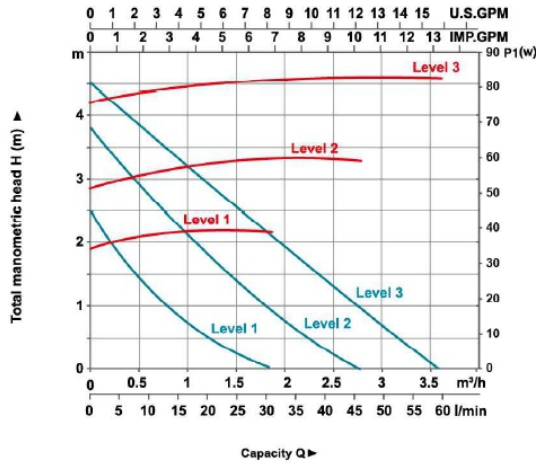

LRP25-50/180
 — Q-H
 — Q-P

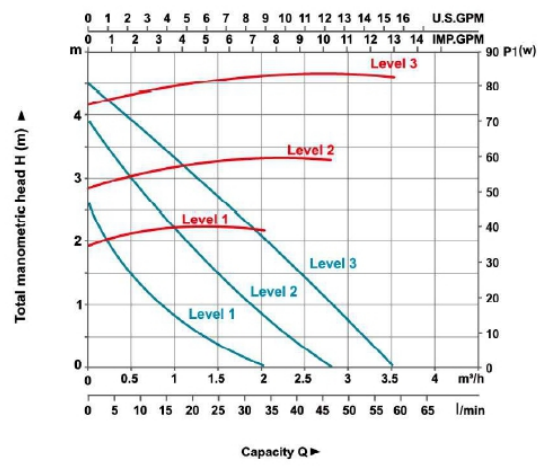

LRP32-50/180
 — Q-H
 — Q-P

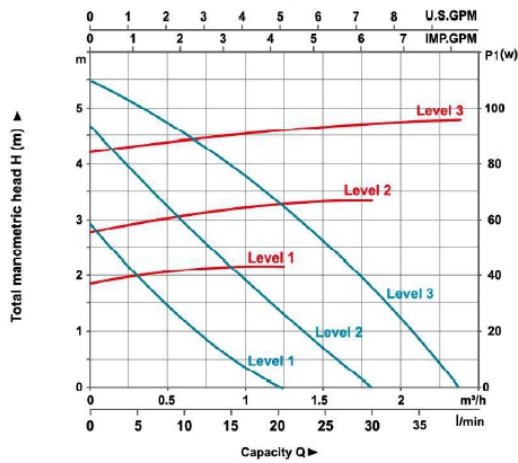

LRP15-60B/130
LRP15-60/130
 — Q-H
 — Q-P

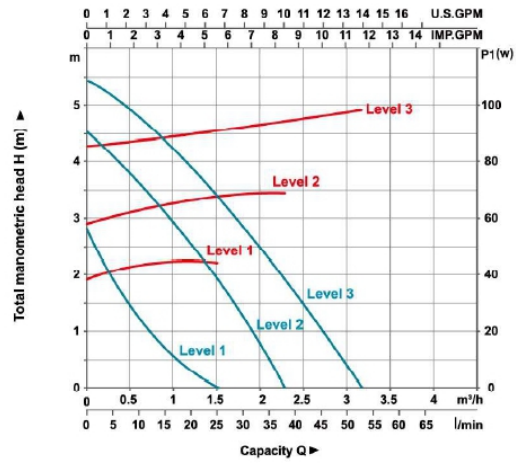

LRP20-60/130
 — Q-H
 — Q-P

Hydraulic Performance Curves

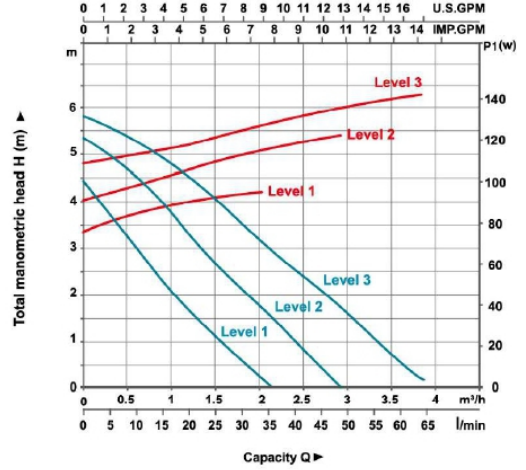
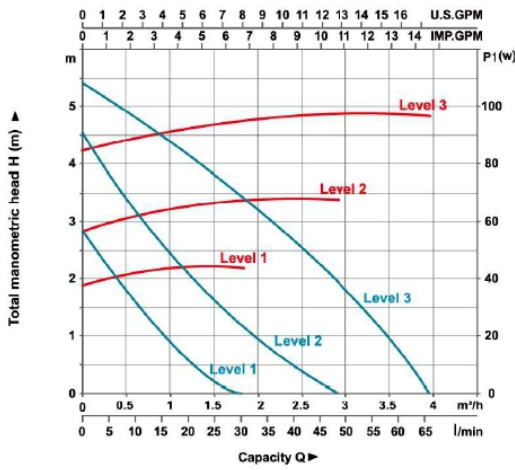
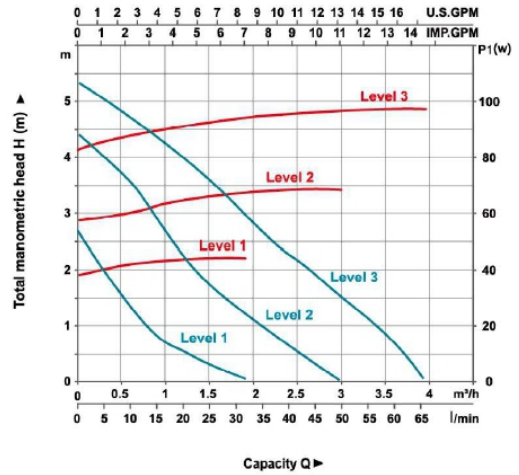
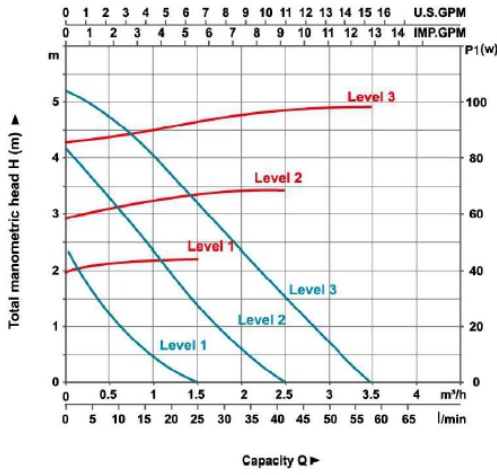

LRP

Circulation Pump



Connectors on request



Application

It is widely used for

- Pressure boosting for domestic water supply
- Floor heating system
- Solar pumping system

Pump

- Automatic pressure boosting
- Anti-rust cast iron pump body
- Noryl impeller with heat resistance up to 150°C
- 95% alumina ceramic shaft
- Liquid temperature: 2°C - 60°C

Motor

- Insulation class: H
- Protection class: IP42
- 99% alumina ceramic bearing
- Copper winding

Identification Codes

LRP 15 - 90 A / 160

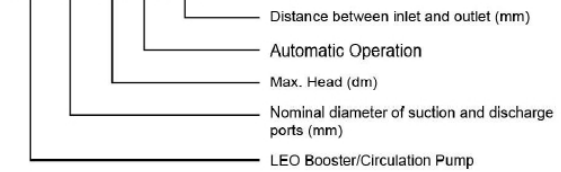

Technical Data

Model	Voltage/ Frequency	Power (W)	Max.Flow (l/min)	Max.Head (m)	N.W. (kgs)	G.W. (kgs)	Packing Size (mm)
LRP15-90A/160	1~230V/50Hz	120	25	9	2.72	2.74	198x143x160

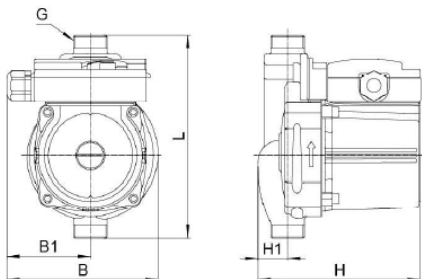

Dimension Drawing

Model	L (mm)	B (mm)	B1 (mm)	H (mm)	H1 (mm)	G
LRP15-90A/160	160	120	70	130	25	G3/4

Hydraulic Performance Curves

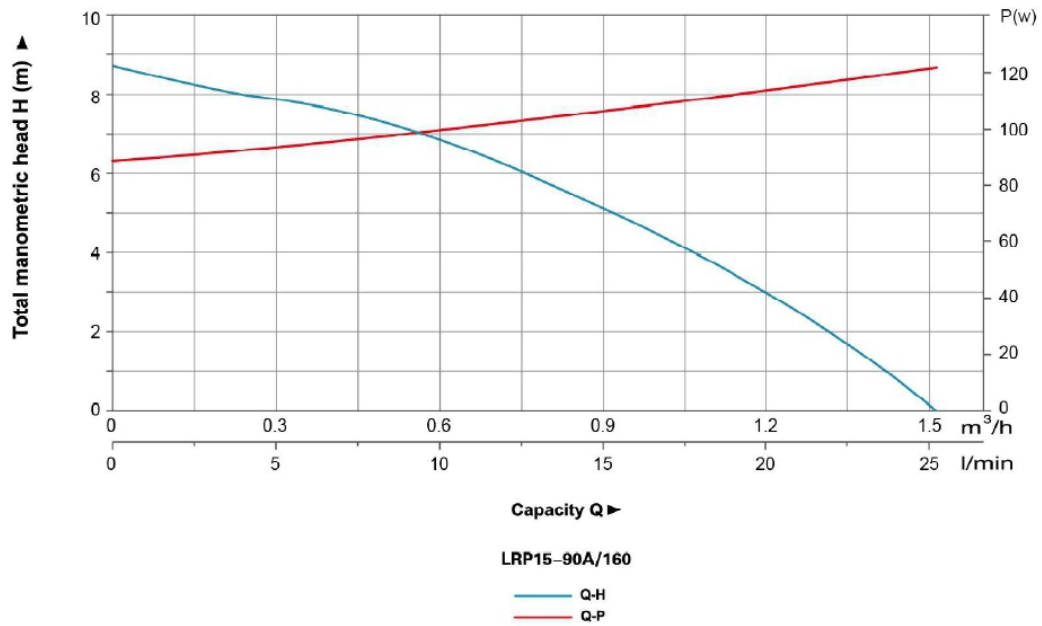

Materials Table

No.	Part	Material
1	Rotor	
2	Thrust bearing adjusting mat	Noryl
3	Thrust ring support	Silicon rubber
4	Bushings	Graphite
5	Front bearing	Alumina
6	Pump support cover	Stainless steel
7	Check ball	Silicon rubber
8	Impeller	PPO
9	Pump body	Cast iron/bronze
10	Pump body insert	Stainless steel
11	Body gasket	
12	Rear bearing	HT200
13	Can brg asm	Stainless steel
14	Can brg asm seal	Silicon rubber
15	Stator cover(front)	PA66
16	Stator sleeve	
17	Stator cover(back)	PA66
18	Housing	ADC12
19	Cable outlet nut	ABS
20	Button	ABS
21	Terminal box	PA6
22	Regulation switch	
23	Capacitor	
24	Terminal cover	ABS
25	Flow switch assembly	

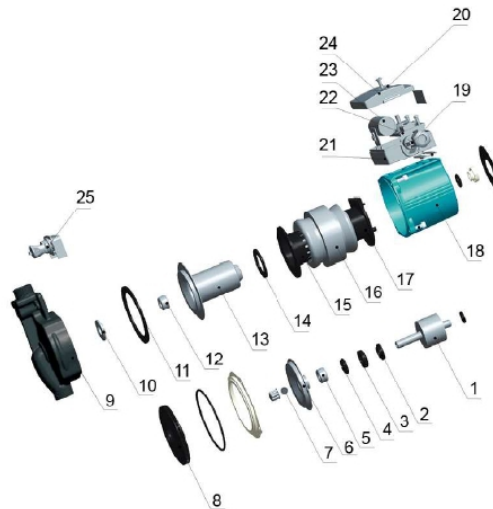



Hydraulic Performance Curves

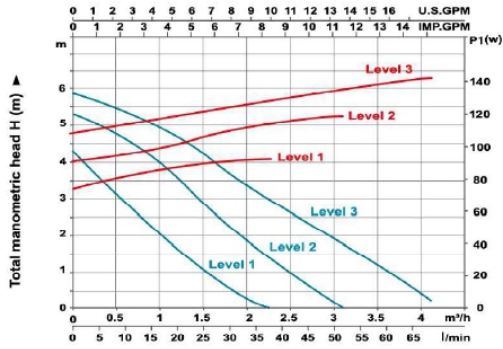

Capacity Q ►
LRP25-70/180
— Q-H
— Q-P

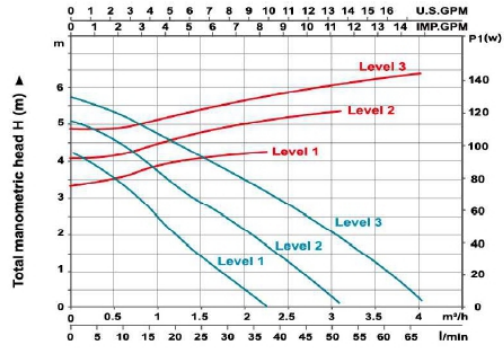

Capacity Q ►
LRP32-70/180
— Q-H
— Q-P

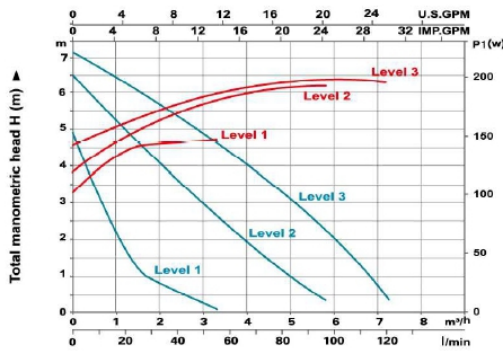

Capacity Q ►
LRP25-80/180
— Q-H
— Q-P

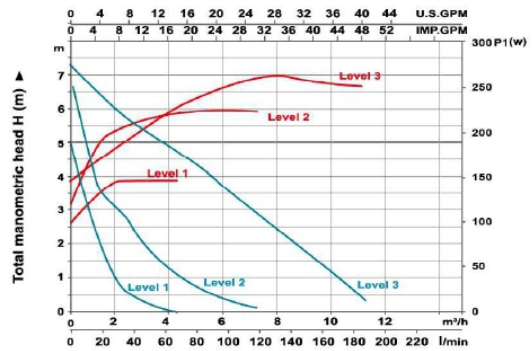

Capacity Q ►
LRP32-80/180
LRP32-80/220
LRP36-80/200
— Q-H
— Q-P

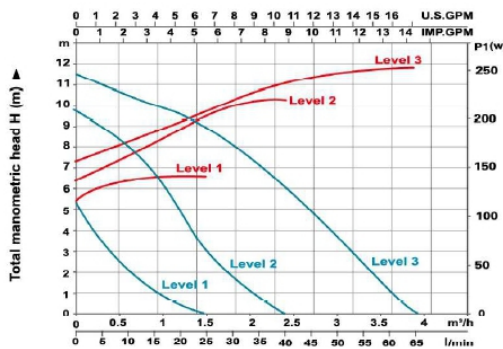

Capacity Q ►
LRP25-120/180
— Q-H
— Q-P

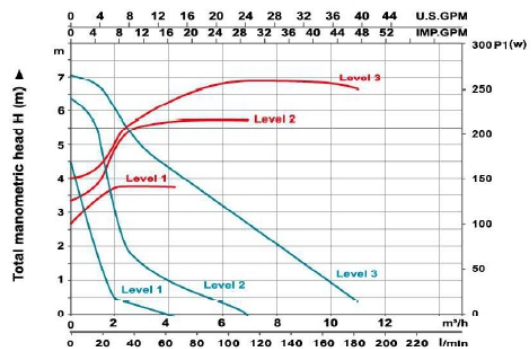

Capacity Q ►
LRP40-80F/250
— Q-H
— Q-P