

# USER MANUAL

## Smart Soil Moisture Sensor

Model No. HCS026FRF



Welcome to the **RAINPOINT** family! Please read the manual before use to learn about the features and functions.

# Contents

<b>1. Contents in the box</b>	<b>01</b>
<b>2. Introduction</b>	<b>02</b>
2.1 Product Overview	02
2.2 Specifications	02
2.3 Functions	03
<b>3. Installation &amp; Pairing</b>	<b>04</b>
3.1 Installing the Battery	04
3.2 Pairing the soil meter with WiFi hub	05
<b>4. Troubleshooting</b>	<b>07</b>
<b>5. Precautions</b>	<b>07</b>
<b>6. Warranty Policy</b>	<b>07</b>
<b>7. FCC Statement</b>	<b>08</b>
<b>8. Customer Support</b>	<b>09</b>

# 1. Contents in the box



1

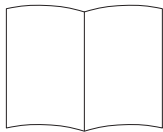

2

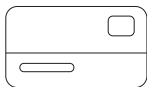

3

1. HCS026FRF Smart Soil Moisture Meter
2. User Manual
3. Warranty Card

## 2. Introduction

### 2.1 Product Overview

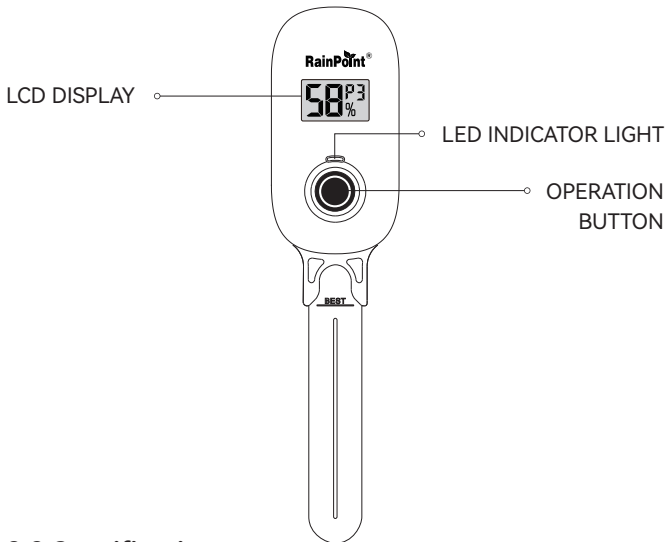

### 2.2 Specifications

- **Working Environment:** Temperature  $-20^{\circ}\text{C}\sim 60^{\circ}\text{C}$ , Humidity: 10%~90%
- **Preservation:** Temperature  $-20^{\circ}\text{C}\sim 70^{\circ}\text{C}$ , Humidity: 15%~95%
- **Humidity Range:** 1% RH~99%RH
- **Probe Length:** 11cm
- Power by 3\*AAA batteries (Not included)

## 2.3 Functions

- **Moisture Detection**

**Auto detection:** Insert the soil meter into the soil, and automatically detect soil moisture level every 1 min. The reading on app will be refreshed every 8 mins or when the change on moisture level is greater than 5%.

**Manual detection:** Short press the button to detect the current soil moisture level immediately.

- **Low Moisture Level Alert**

The LED light will flash red every 10 seconds when the moisture level is less than 15%.

- **Low Power Indicator**

Replace the battery when the low battery indicator  appear on display.

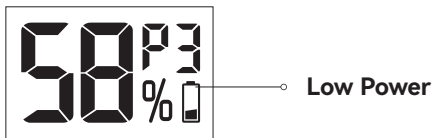

## 3. Installation & Pairing

### 3.1 Installing the Battery

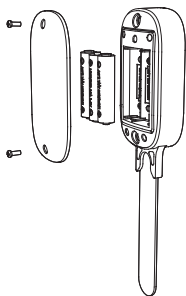

1. Unscrew the battery compartment.

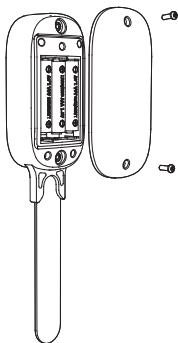

2. Insert the batteries and tighten the screw.

## 3.2 Pairing the soil meter with WiFi hub

**Note:** This smart soil moisture meter can be used alone or paired with RainPoint WiFi hub.

If you already have the hub, just simply add soil meter under the hub you would like to pair with.

If you don't have existing hub, please refer to hub user manual to download app and connect the hub with WiFi first.

1. After the hub is successfully connected with WiFi, select **+** button on app home page or click **"Add Device"** on hub home page.

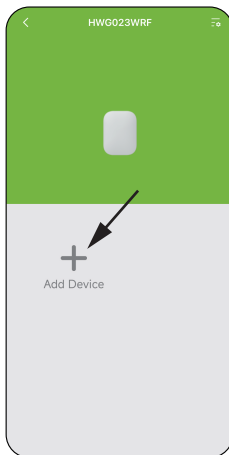
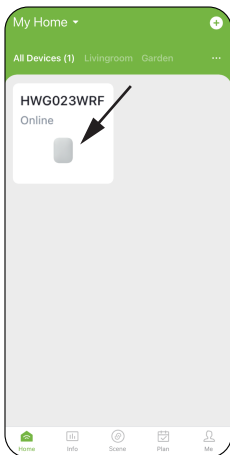

2. Then select **"HCS026FRF"** or tap  icon on Add Device page, and scan QR code below.

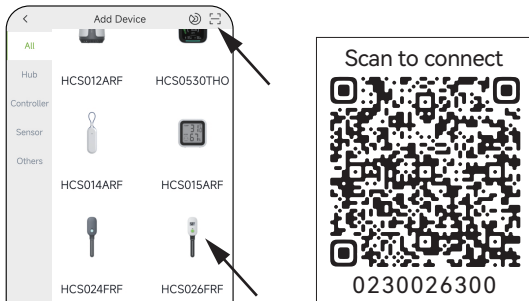

3. Click Next and move onto Pairing page. Follow the in-app instruction to complete the pairing.

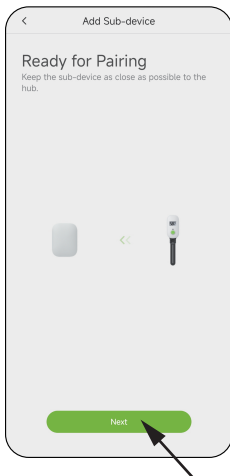

## 4. Troubleshooting

Problem	Possible Reason	Solution
Inaccurate reading	<ul style="list-style-type: none"><li>• Touch stones or hard rock soil.</li><li>• Not inserted deep enough into the soil.</li></ul>	<ul style="list-style-type: none"><li>• Please avoid stones or hard rock soil around the sensor.</li><li>• Reinsert the sensor into the soil to reach the BEST line. The reading might not be accurate if it's loosely inserted.</li></ul>
No display on the screen	Batteries are low.	Replace brand new alkaline batteries.
Soil meter can't pair with hub	<ul style="list-style-type: none"><li>• Too far from the hub or too many obstructions between soil meter and hub.</li><li>• Miss the searching time during connecting.</li><li>• The hub firmware version is too low.</li></ul>	<ul style="list-style-type: none"><li>• Stay close with the hub when pairing with soil meter.</li><li>• Try to reconnect the soil meter by following the in-app instructions.</li><li>• Go to hub home page, click "Firmware Version" to update firmware version.</li></ul>

## 5. Precautions

- Please make sure to use 2.4GHz band WiFi to connect to this product.
- Do not mix old and new batteries or different types of batteries.

## 6. Warranty Policy

**RAINPOINT** provides a 1-year limited warranty on this product against manufacturing defects in materials and workmanship. You can get an extra two years of extended warranty by registering your product on our website [www.rainpointonline.com](http://www.rainpointonline.com)

## 7. FCC Statement (FCC ID: 2AWDBHCS026FRF)

This device complies with Part 15 of the FCC Rules. Operation is subject to the following two conditions:

1. This device may not cause harmful interference.
2. This device must accept any interference received, including interference that may cause undesired operation.

**FCC Warning:** Any changes or modifications not expressly approved by the party responsible for compliance could void the user's authority to operate this equipment.

**Note:** This equipment has been tested and found to comply with the limits for a Class B digital device, pursuant to Part 15 of the FCC Rules. These limits are designed to provide reasonable protection against harmful interference in a residential installation. This equipment generates, uses, and can radiate radio frequency energy, if not installed and used in accordance with the instructions, may cause harmful interference to radio communications. However, there is no guarantee that interference will not occur in a particular installation. If this equipment does cause harmful interference to radio or television reception, which can be determined by turning the equipment off and on, the user is encouraged to try to correct the interference by one of the following measures:

- Reorient or relocate the receiving antenna.
- Increase the separation between the equipment and the receiver.
- Connect the equipment into an outlet on a circuit different from that to which the receiver is connected.
- Consult the dealer or an experienced radio/TV technician for help.

**Note:** The manufacturer is not responsible for any radio or TV interference caused by unauthorized modifications to this equipment. Such modifications could void the user's authority to operate the equipment.

## 8. Customer Support

If you find it difficult to set up and want to watch the setting tutorial video, please subscribe to our channel RainPoint on YouTube.



Or scan the QR code to visit the RainPoint channel on YouTube quickly.

If you encounter any issues during setup, please feel free to email our customer support team.

**Email:** [support@rainpointonline.com](mailto:support@rainpointonline.com)



Made in China



Not included



Points de collecte sur [www.quefairedemesdechets.fr](http://www.quefairedemesdechets.fr)  
Privilégiez la réparation ou le don de votre appareil !

## Need Help ?

Scan the QR code for more help.



or Email:

[support@rainpointonline.com](mailto:support@rainpointonline.com)

