

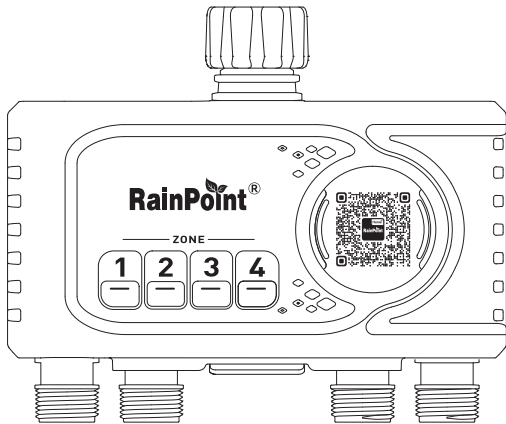

# USER MANUAL

## 4-ZONE Wi-Fi WATER TIMER

Model No. HTV405FRF



Welcome to the **RAINPOINT** family! Please read the manual before use to learn about the features and functions.

# Contents

<b>1.</b>	<b>Box Contents</b> .....	<b>01</b>
<b>2.</b>	<b>Introduction</b> .....	<b>02</b>
	2.1 Product Overview .....	<b>02</b>
	2.2 Specifications .....	<b>03</b>
	2.3 Product Features .....	<b>03</b>
<b>3.</b>	<b>Connection</b> .....	<b>04</b>
<b>4.</b>	<b>Installation</b> .....	<b>08</b>
<b>5.</b>	<b>Features And Functions</b> .....	<b>11</b>
	5.1 Device Home Page .....	<b>11</b>
	5.2 Basic Settings .....	<b>12</b>
	5.3 Plan Settings .....	<b>14</b>
	5.4 Manual .....	<b>15</b>
<b>6.</b>	<b>Smart Page</b> .....	<b>16</b>
<b>7.</b>	<b>Share With Family Members</b> .....	<b>18</b>
<b>8.</b>	<b>Troubleshooting</b> .....	<b>21</b>
<b>9.</b>	<b>Precautions</b> .....	<b>22</b>
<b>10.</b>	<b>Warranty Policy</b> .....	<b>22</b>
<b>11.</b>	<b>FCC Statement</b> .....	<b>23</b>
<b>12.</b>	<b>Customer Support</b> .....	<b>24</b>

# 1. Box Contents

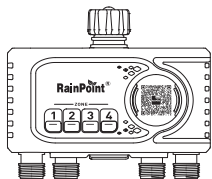

1



4



2



3



5



6



7



9



11



13



8



10



12



14

1. 4-Zone Wi-Fi Water Timer X 1	8. Bracket Accessory X 1
2. User Manual X 1	9. Small Screw X 2
3. Warranty Card X 1	10. Thick Shim X 1
4. Nut X 1	11. Big Screw X 1
5. Quick Guide X 1	12. Middle Screw X 1
6. Brace X 1	13. Sealing Tap X 1
7. Thin Shim X 2	14. Spare Rubber Washer X 1

## 2. Introduction

### 2.1 Product Overview

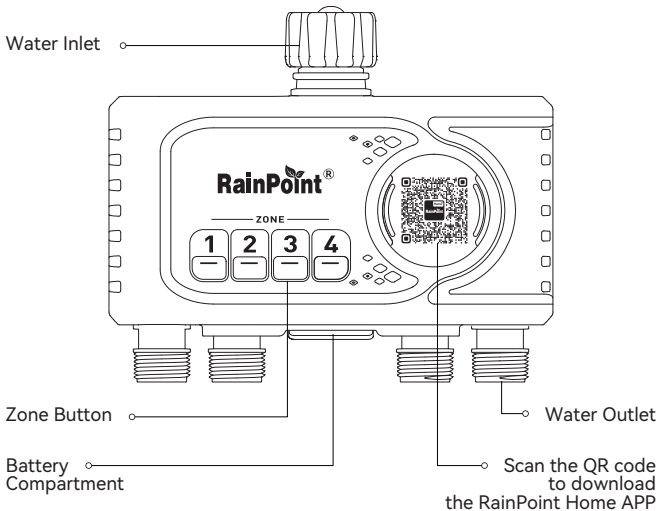

## 2.2 Specifications

- **Range Between Gateway And Timer:** An open distance up to 150m/492ft
- **Working Water Pressure:** 0.5 bar to 8 bar (7.25-116PSI)
- **Water Flow Rate:** 5-35 L/Min (1.32-9.25GAL/Min)
- **Working Temperature Range:** 3°C-50°C (37.4°F-122°F)
- Powered By 4\*AA alkaline batteries (not included)
- **Waterproof Level:** IP65
- **Water Inlet:** NH (US) for 3/4" faucets, BSP (EU) for 3/4" or 1" faucets
- **Water Outlet:** For 3/4" standard garden hose

### Tips:

- Not For Use With Appliances.
- Do Not Mix Alkaline, Standard (Carbon-Zinc), or Rechargeable (Nickel Cadmium) Batteries.
- Used up or dead batteries must be removed from the timer and disposed of properly.
- For Outdoor Use With Cold Water Only.

## 2.3 Product Features

- WiFi remote controlled
- **3 watering modes:** Irrigation/ Interval/ Cycle & Soak
- Compatible with Amazon Alexa and Google Assistant voice control
- Monitor the watering progress according to the soil temperature and humidity from soil sensor
- Auto start or stop watering base on soil moisture level
- Smart schedule suggestions

## 3. Connection



**Tips:** Scan the QR code or search the URL below to watch the video which will guide you through the basics, from setting up your timer to using unique features.

**Video Address:** [www.youtube.com/@rainpoint](http://www.youtube.com/@rainpoint)

### Pair timer with hub

In order to remote control and manage irrigation plans, this timer needs to be paired with hub. Please refer to hub user manual to download app and connect the hub with WiFi network first.

1. After the hub is successfully connected with WiFi, select hub device on app home page, touch **"Add Device"** on hub home page.

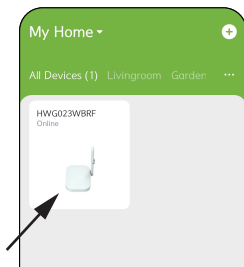

2. Select the category "**Controller**" on the left and then find model "**HTV405FRF**", or press  on the top right corner to scan product QR code and enter pairing below.

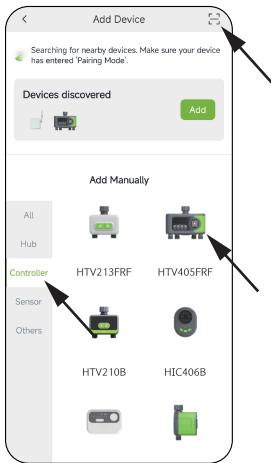

0220405300

3. Tap Next and move onto Pairing page.

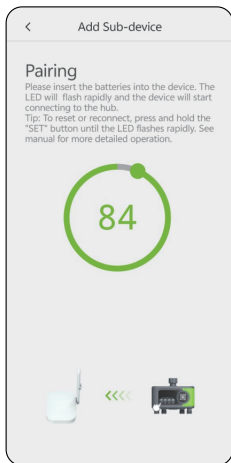
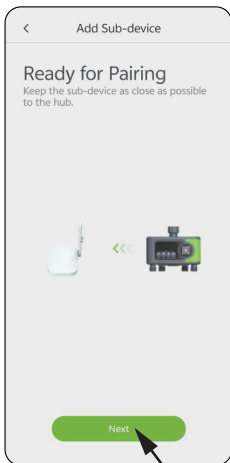

4. **Insert 4 new AA alkaline batteries** (NOT Included). And press and hold the **Operation Button** for 5 seconds until the indicator flash red quickly. Then the timer will start pairing automatically

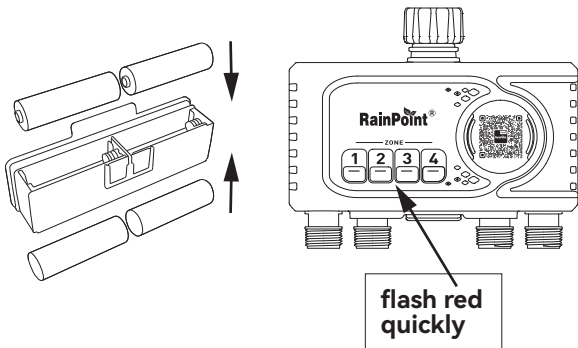

**Tips:**

- Make sure your hub and timer stay close together during pairing.
  - If at any time you need to re-pair or do a factory reset, press and hold the **Operation Button** until the red indicator light flashes quickly to activate pairing mode manually
5. After successfully connecting, the next watering plan time will display on the middle of **Device Home Page** after you create plans.

## 4. Installation

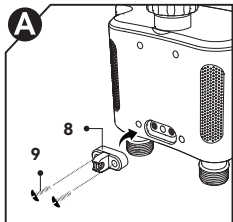

Firstly, before installing timer to faucet, please screw the **"Bracket Accessory"** onto the back of the water timer with 2 screws.

**Parts used in this step:**

- ⑧ **Bracket accessory X 1,**
- ⑨ **Small screw X 2.**

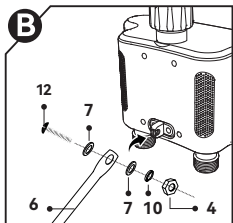

Secondly, use a screw to fix the **"Brace"** onto the **"Bracket Accessory"** through the hole.

**Parts used in this step:**

- ⑥ **Brace X 1, ⑦ Thin shim X 2,**
- ⑩ **Thick shim X 1, ④ Nut X 1,**
- ⑫ **Middle screw X 1.**

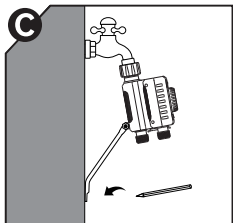

Then installing the timer to the faucet properly. Please turn to page 6 for instruction. After that, please mark a proper position with a pencil before installing the brace onto the wall.

**Parts used in this step:**

- Pencil X 1 (not included).**

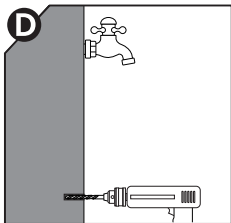

At the marked place, drilling a hole on the wall for screwing.

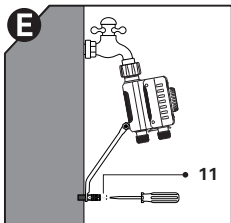

At last, fix the other end of the brace to the wall.

**Parts used in this step:**

⑪ **Big screw X 1.**

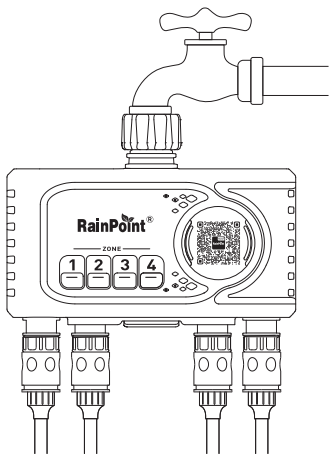

**NOTE:**

1. Install your Smart Timer as vertically to the ground as possible. Avoid material fatigue caused by horizontal or angled connections.
2. For better signal connection with the Wi-Fi hub, please do not place the timer in an underground valve box.

## 5. Features And Functions

### 5.1 Device Home Page

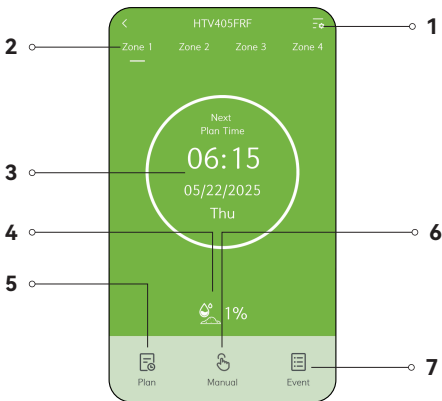

1. **Setting:** Basic settings for the hose timer
2. **Zone 1/2/3/4:** Choose to manage plans or manual watering for the 4 zones
3. **Next Plan Time:** The next watering time will be displayed here If you set up a watering schedule
4. **Soil temperature & moisture:** Display soil data if you add a paired RainPoint WiFi Soil Sensor
5. **Plan:** Create and manage watering plans
6. **Manual:** Manual watering in Irrigation, Interval(Misting), Cycle & Soak mode
7. **Event:** View execution history for the past year

## 5.2 Basic Settings

Find the icon  on the top right corner of the Device home page to "Settings" page.

### Device Name

Edit the name of the timer.

### Device Information

Check Device ID, model #, battery level and firmware version.

### Device Replacement

Replace the timer with a new one while keep the irrigation plans and sensor data record from the old timer.

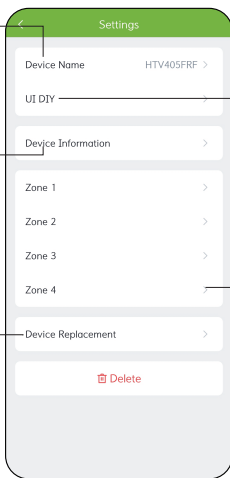

### UI DIY

Choose front color & background picture.

### Zone 1/2/3/4

Set some advanced Settings for specific functions, like enable Smart Plan Recommendation/Set interval Irrigation/Select Soil Sensor etc.

**Tips:** After enabling Smart Plan Recommendation, the recommended values will be displayed as shown below.

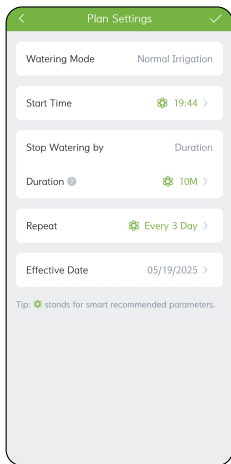
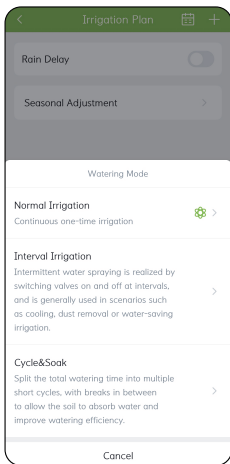

## 5.3 Plan Settings

Select **Plan**  and start to create a new auto-watering plan.

### Rain Delay

The timer will skip all plans during the selected period (24/48/72 hrs) to prevent overwatering. Apply on rainy days or other weather conditions that cause high soil moisture.



Turn the plan on or off

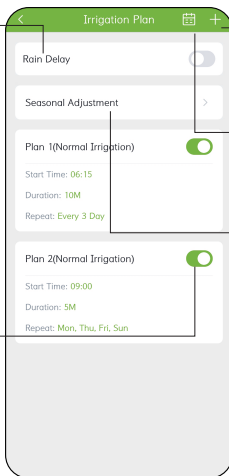

Add a new irrigation plan



Timetable overview of all plans

### Seasonal Adjustment

Set and Adjust the water consumption of irrigation plan by percentage according to monthly seasonal climate conditions

**Tips:** Up to 6 plans each outlet can be created.

## Watering Mode

Select an irrigation mode (Normal Irrigation/ Interval Irrigation/Cycle & Soak)

## Start Time

Set the time that the plan starts

## Duration

Set a watering duration for the plan from 1min to 12 hrs as desired

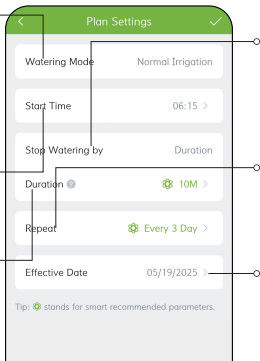

## Stop Watering by

Select a way to stop watering, Duration or Water Usage

## Repeat

Set the watering frequency for your plan

## Effective Date

The start date for the implementation of the watering plan

## Tips:

- **Irrigation Mode:** Normal watering mode with basic start time, duration and frequency
- **Interval Irrigation Mode:** Special mist time and interval period that can intermittent quick watering
- **Cycle & Soak Mode:** Customized watering and soaking cycle times for deep irrigation and full absorption

## 5.4 Manual

1. **Irrigation:** Select Irrigation on Device Home Page to manually start a temporary plan with a settable time.
2. **Interval (Misting):** Select Interval to manually start a temporary misting plan. Set a specific set of short interval valve opening and closing times to achieve intermittent water spraying.
3. **Cycle & Soak:** Select Cycle & Soak to manually initiate a temporary intermittent cycling plan for deep irrigation.

**Note:** If a plan is running when manual watering is started, or if a plan is about to run during the current manual period, it will be skipped this time.

## 6. Smart Page

Set up customized **Smart Scenes** according to your preferences and needs to build RainPoint's device IoT system. In this way, your hose timer will automatically adjust watering plans and send various notifications based on the plants' environment.

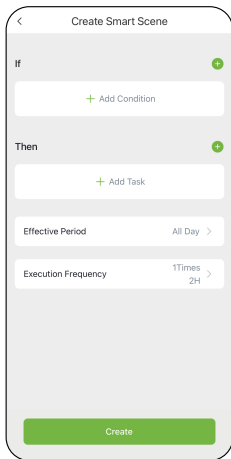
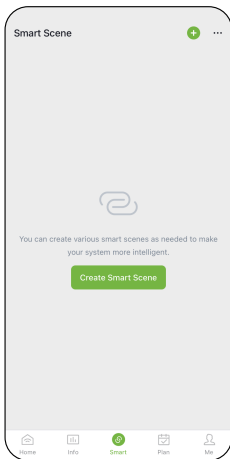

Follow the in-app instructions to complete **Smart Scene** settings.

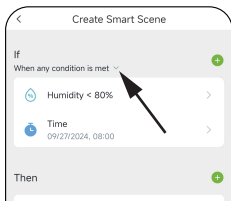

## Tips:

- **Smart Scene Operation logic:** "If" selected condition is triggered, "Then" execute the specified task.
- Up to **5 conditions** and **5 tasks** can be added.
- In **Time** condition pane, **Execution Time** can be set to the sunrise/sunset time at your location (based on in-app weather forecast).
- **Conditions Trigger Relationship Setting:** Touch the icon  below **If**. Here you can select the type of trigger relationship between multiple conditions.



- Tap the icon  on the upper right corner of **Smart Page**, and tap **Manage** to delete scenes.
- Tap the icon , tap **Logs** to view execution history.

## 7. Share With Family Members

**Tips:** To achieve joint management of multiple mobile phones/multiple members, it is necessary to set up a separate account for each mobile phone/each member and log in on different mobile devices (tablets, cellphones).

1. Select on the **"Me"** page at the bottom right, enter into **"HOME Management"**. And then Select the group you set up earlier.

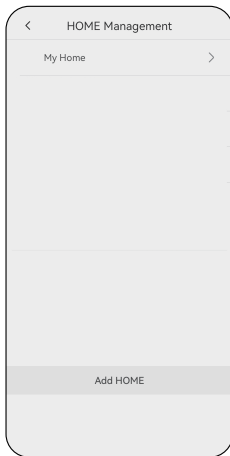
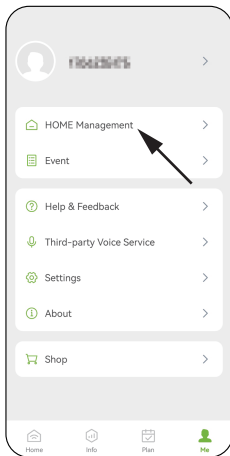

2. Tap on **"Members"** and press **+** on the top right corner.

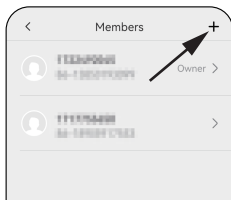
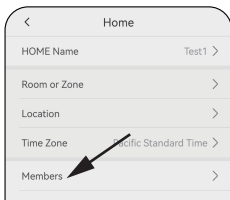

3. Enter the email or mobile number of the invited member (the member need to complete the account registration in the APP on his mobile phone). Then select **"Invite"** and tap **"Accept"** in the invited phone app.

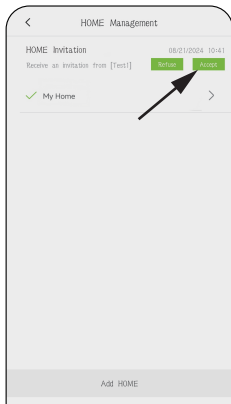
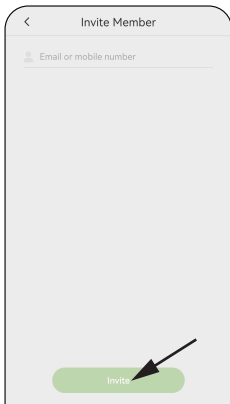

4. On the **"Members"** page of the owner APP, select the member you want to adjust, and then tap **"Admin"** to adjust the member's permission.

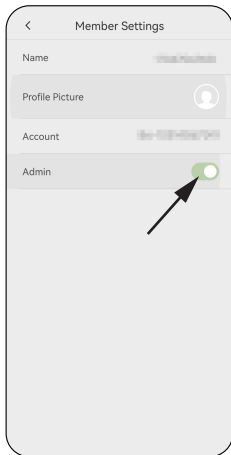
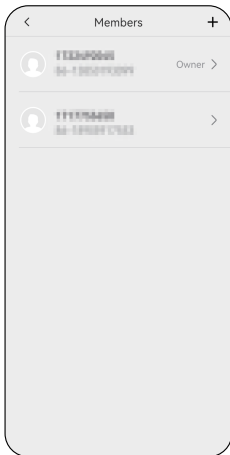

## 8. Troubleshooting

<b>Problem</b>	<b>Possible Factors</b>	<b>Some Solutions</b>
Unable to open the valve.	<ul style="list-style-type: none"><li>• Low battery.</li><li>• Debris in the inlet.</li><li>• Unstable network or response delay.</li></ul>	<ul style="list-style-type: none"><li>• Replace with new batteries.</li><li>• Regularly clean the debris in the filter to avoid interference with use.</li><li>• Wait a moment and try opening the valve again.</li></ul>
Timer cannot connect.	<ul style="list-style-type: none"><li>• WiFi network is unstable.</li><li>• Too far from the hub.</li><li>• Timer is not in pairing mode.</li></ul>	<ul style="list-style-type: none"><li>• Please check whether the WiFi network environment is functioning properly.</li><li>• When connecting to the irrigation timer, stay close to the gateway and router.</li><li>• Re-pair the timer: press and hold the timer button until the red light flashes quickly, indicating pairing (or remove the device from the homepage and reconnect).</li></ul>
Not executing as scheduled.	<ul style="list-style-type: none"><li>• Impurities in the water have entered the filter.</li><li>• Rain delay has been set.</li><li>• In low power mode, the timer enters low power protection mode and does not execute the schedule.</li></ul>	<ul style="list-style-type: none"><li>• Please check whether the WiFi network environment is functioning properly.</li><li>• When connecting to the irrigation timer, stay close to the gateway and router.</li><li>• Re-pair the timer: press and hold the timer button until the red light flashes quickly, indicating pairing (or remove the device from the homepage and reconnect).</li></ul>

## 9. Precautions

The WiFi water timer should be stored indoors in a warm, dry place during the winter months when temperatures consistently drop near or below freezing.

- Turn off the water faucet.
- Disconnect hoses from timer outlets and disconnect timer from the faucet.
- Press the zone buttons to open the valves to drain residual water from inside the timer. Gently blow into top inlet to clear additional remaining water, until no more water drains out.
- Press the zone buttons again to close the valves.
- Remove the batteries and recycle or discard them. (For next watering season, fresh batteries must be used.)
- Loosely cover the inlet with a plastic plug, and outlets with plastic caps (available at hardware and garden stores), and/or place timer in a sealable plastic bag, to prevent bugs and other debris from entering the timer during storage.

## 10. Warranty Policy

**RainPoint** provides a 1-year limited warranty on this product against manufacturing defects in materials and workmanship.

## 11. FCC Statement (FCC ID: 2AWDBHTV405FRF)

This device complies with Part 15 of the FCC Rules. Operation is subject to the following two conditions:

1. This device may not cause harmful interference.
2. This device must accept any interference received, including interference that may cause undesired operation.

**FCC Warning:** Any changes or modifications not expressly approved by the party responsible for compliance could void the user's authority to operate this equipment.

**Note:** This equipment has been tested and found to comply with the limits for a Class B digital device, pursuant to Part 15 of the FCC Rules. These limits are designed to provide reasonable protection against harmful interference in a residential installation. This equipment generates, uses, and can radiate radio frequency energy, if not installed and used in accordance with the instructions, may cause harmful interference to radio communications. However, there is no guarantee that interference will not occur in a particular installation. If this equipment does cause harmful interference to radio or television reception, which can be determined by turning the equipment off and on, the user is encouraged to try to correct the interference by one of the following measures:

- Reorient or relocate the receiving antenna.
- Increase the separation between the equipment and the receiver.
- Connect the equipment into an outlet on a circuit different from that to which the receiver is connected.
- Consult the dealer or an experienced radio/TV technician for help.

**Note:** The manufacturer is not responsible for any radio or TV interference caused by unauthorized modifications to this equipment. Such modifications could void the user's authority to operate the equipment.

## 12. Customer Support

Please subscribe to our channel: **RainPoint** on YouTube for tutorial videos.



Or scan the QR code to visit the **RainPoint** channel on YouTube.

If the app and the user manual don't have what you're looking for, and need some help about **RainPoint**, please contact us by **LOT NO.:** XXXXXX (on the back of the device)

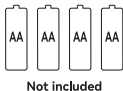

Points de collecte sur [www.quefairedemesdechets.fr](http://www.quefairedemesdechets.fr)  
Privilégiez la réparation ou le don de votre appareil !



## Need Help ?

Scan the QR code for more help



or Email:

[support@rainpointonline.com](mailto:support@rainpointonline.com)